

Battery Powered Security Camera

BCS0247 V1.0

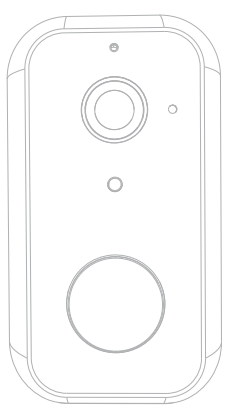

Quick Guide

Note: The camera picture in the user manual for reference only, please take the physical object as the standard.

Content

- What 's in the box01
- Product structure02
- App operation guide03
- How to setup(Wireless connection)04
- Installation05
- App function display 1-106
- App function display 1-207
- Camera Settings08
- Functions09
- Precautions10

What 's in the box

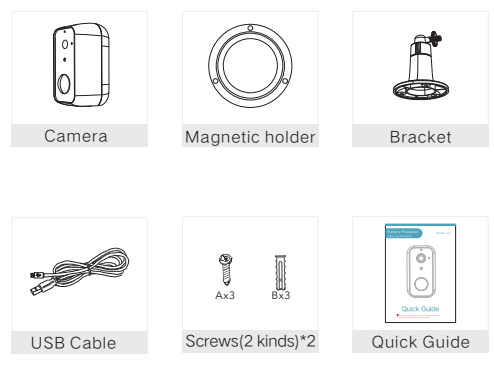

Product structure

Power port DC 5V ±10%

Power on/off Press the button for 3 seconds to turn on/off the camera

Status light

- Solid red light on: the camera is turning on or malfunctional
- Blinking red light: awaiting WIFI connection (slowly blinking) connecting the WIFI (quickly blinking)
- Blinking blue light: currently connecting
- Solid blue light on: the camera runs correctly

SD card slot Support local SD card storage (Max.128G)

Reset Press and hold on for 5 seconds to reset the camera

Charging

- Solid red indicator on: battery is charging
- Solid blue indicator on: charging completed

Battery capacity 10000mAh (two 21700 lithium-ion batteries)

App operation guide

Download the APP
Scan the below QR code or Search "Cloudedge" on Google play / App store to download the app

User Sign up
You can sign up an account by email , Click "Sign up" then select the country or region you are located and complete your register

How to setup (Wireless connection)

1. Place the camera and phone within 30cm-100cm of the router, then connect the phone to wifi.

2. **Power on the camera**
Press and hold the power button for 5 seconds to turn on the camera ,if can not power on , please plug in DC5V 1A/2A phone adaptor to charge 15min firstly ,ensure the indicator slowly blinking in red (if not blinking red,press the reset button 5 seconds to reset the camera)

3. **Add the camera**
Log in Cloudedge APP, click + and select "Battery Camera".
Select 2.4GHz wifi SSID and enter your password, tap "Next".
Scan the QR code in front of the camera , after the device recognizes the QR code , it will sound "bugu" then tap "hear Tone"

Camera will start connecting wifi and skip to the page where the connection is successful , you can edit the camera name , then click "Done" to open the camera in my device list and you can watch the live video .

Installation

Mode 1 Bracket (A) Installation

1. Fix the bracket on the wall with screws
2. Bring the camera closer to the bracket

Mode 2 Bracket (B) Installation

1. Fix the bracket on the wall
2. Install the camera in the bracket and lock it with the screw

After adjusting your camera angle, please lock this screw

App function display 1-1

Video playing

- 1 Add a camera
- 2 Camera time
- 3 Live video play
- 4 Camera name
- 5 Alarm video/Alarm screenshot
- 6 Cloud storage
- 7 Devices list
- 8 Alarm and system message
- 9 Personal homepage

App function display 1-2

- 10 Camera Settings
- 11 Battery capacity
- 12 SD/HD options
- 13 Full screen
- 14 Sound on/off
- 15 Live Video
- 16 TF card video playback
- 17 Cloud video playback
- 18 Mobile recording
- 19 Press and hold to talk
- 20 Screenshot
- 21 Body Detection (Default is on, click again)

Camera Settings

- 1 Rename the camera
- 2 On/Off the Notifications
- 3 Share the device
- 4 Device Information
- 5 function (On/Off Rotate view, Night Vision, Alarm settings, Power Management)
- 6 Detection Alarm
- 7 TF card information
- 8 Cloud Storage Service
- 9 Version
- 10 Delete the camera

Functions

- **Remote wake-up**
The camera will be in a sleep mode to save power, you can have a preview in App
- **Two way Audio**
You can see and talk with the visitor in you App from the camera
- **PIR Body Detection**
BUILT IN PIR with flexible motion sensitivity to avoid false alarms caused by insects. You will receive a notification on your phone once any movement of human is detected.
- **Low battery alarm**
You can set a low-battery alarm threshold in your phone App, the threshold is set to a minimum of 10% and a maximum of 50%.When the battery power of the camera is lower than the set threshold,the App will have a reminder.
- **Record**
Using TF card or enable the Cloud-Storage Service, to keep recording for every moment
- **Day&Night**
Powerful night vision means no interruptions, even in complete darkness.

Precautions

Important Notes for Reducing False Alarms

- Do not install the camera facing any objects with bright lights, including sunshine, bright lamp lights, etc.
- Do not place the camera too close to a place where there are frequently moving vehicles , Based on numerous tests.
- Do not install the camera facing the mirror, Keep the camera at least 1 meter.
- The recommended distance between the camera and vehicles is 15 meters. Stay away from the outlets, including air conditioner vents, humidifier outlets.
- the heat transfer vents of the projectors, etc. away from any wireless devices, including Wi-Fi routers and phones , in order to avoid wireless interference.

Troubleshooting & suggestion		
NO.	Description	Solution and operation
1	Unable To Connect	1. Check your wifi name and password 2. Ensure your wifi is 2.4G, not support 5G 3. Ensure your camera and phone close to router
2	Reset	1. Press and hold on the reset button for 5 seconds 2. Hear "bugu" sound 3. Red light turns to slow blinking
3	Change to new network	1. Press reset key to factory default settings 2. Re-connection
4	Failed to add device	Please Enable Cloudedge App cellular data on mobile settings
5	No alarm push	Please Enable Cloudedge App notification on mobile settings
6	No alarm video record	Please Insert TF Card